

36 Smeaton Court
Herford, SG13 7AL
Guide price £339,995





36 Smeaton Court Hertford, SG13 7AL

The property offers bright and spacious accommodation comprising open plan lounge/kitchen/ dining area, master bedroom with built-in wardrobes, guest bedroom and luxury bathroom.

Benefits include gas central heating and high specification of fixtures and fittings.

Set in stunning well-tended gardens the apartment has gated underground parking.

Accommodation:

Hallway

Lounge/ Dining/ Kitchen Area

Bedroom One





Approximate Gross Internal Area 784 sq ft - 73 sq m

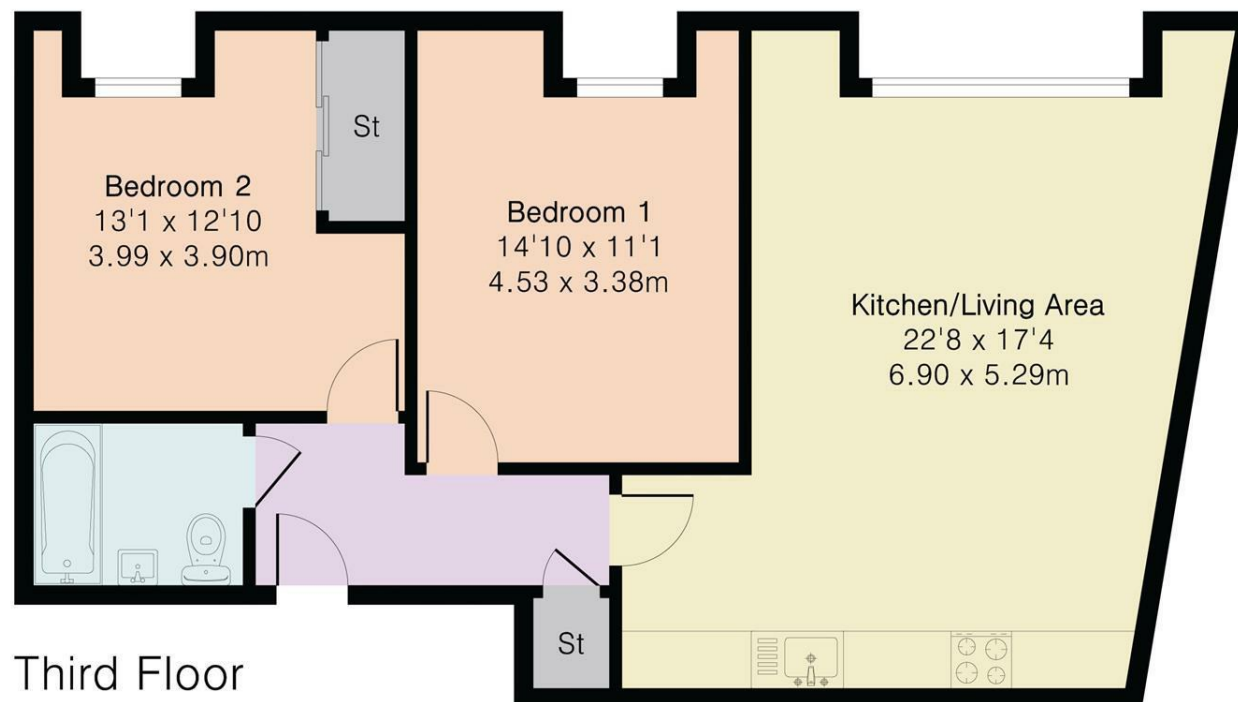

Third Floor

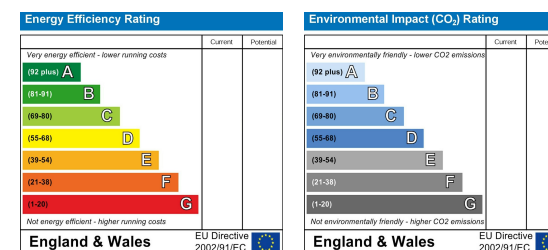

PROPERTY MISDESCRIPTIONS ACT 1991

The agent has not tested any apparatus, equipment, fixtures and fittings, or services, so cannot verify that they are in working order or fit for their purpose or within ownership of the seller, therefore the buyer must assume the information given is incorrect. References to the Tenure of the property are based on information supplied by the Vendor. The agents have not had sight of the title documents. The buyer is advised to obtain verification from their Solicitor. The measurements supplied are for general guidance and as such must not be relied on as fact. Nothing concerning the type of construction or the condition of the structure is to be implied from the photograph of the property. The sales particulars may change in the course of time, and any interested party is advised to make a final inspection of the property prior to exchange of contracts.

morgan-alexander.co.uk



40 Castle Street, Hertford, Herts, SG14 1HH
Tel: 01992 248028
westley@morgan-alexander.co.uk